



IsoBase R50 – Resilient Layer

USES:

- Separating Timber Floors
- Separating Concrete Floors
- New Build & Conversions

BENEFITS:

- Exceeds Part E Requirements
- Provides significant reduction in impact noise and vibration
- Easy to install
- Does not significantly increase the floor level

ISO-BASE R50

IsoBase R50 is designed to provide excellent acoustic sound insulation with ease of installation. The product is designed to be used as a resilient layer underneath T&G chipboard type flooring.

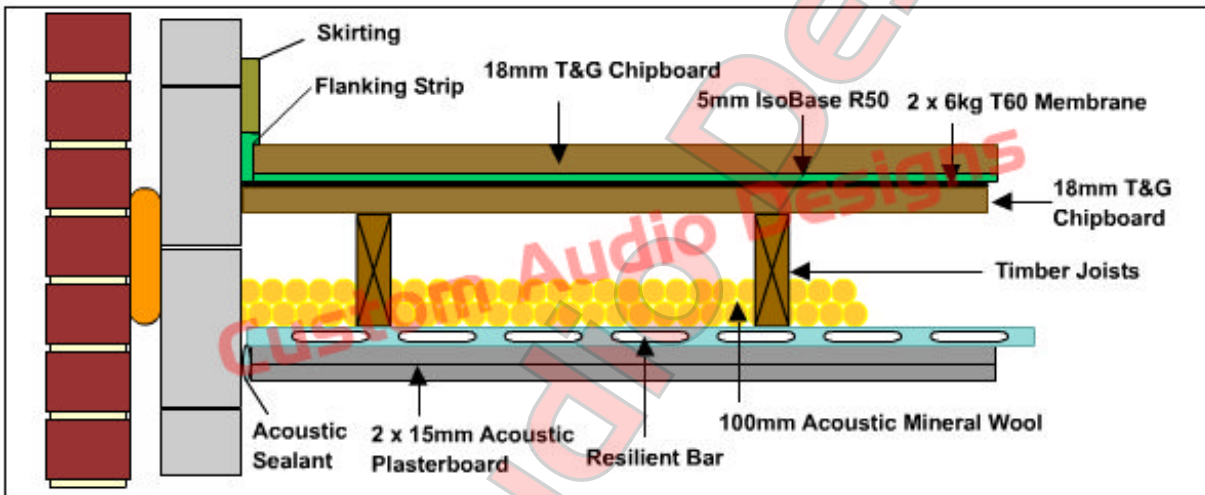

Tested Performance of the Above Structure:-

Airbourne *Impact*
 $R_w=59\text{dB}$ ($C_{tr}=10$) $L_{nw}59\text{dB}$
 $R_w + C_{tr}= 49\text{dB}$

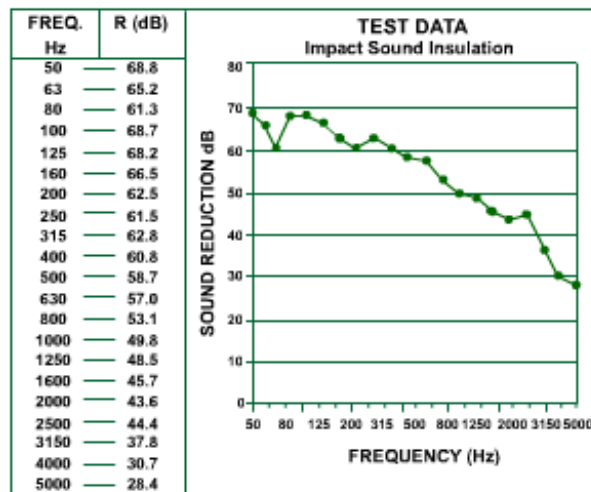
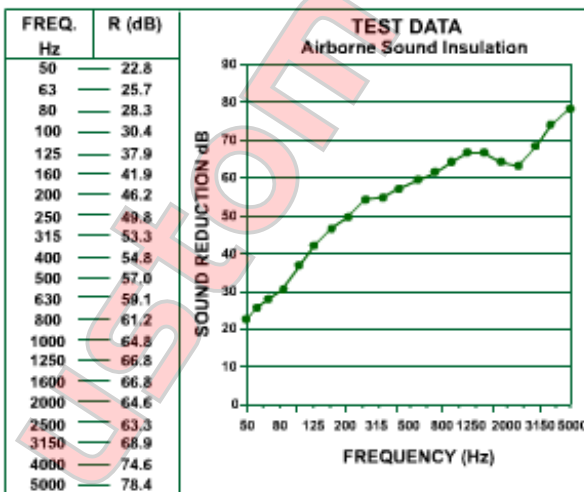

Further improvements can be made by placing 19mm Gypsum based plank over the IsoBase R50 before installing the 22mm T&G Chipboard.

If this is undertaken first then improved results will be in the order of:

Airbourne *Impact*
 $R_w=62\text{dB}$ ($C_{tr}=8$) **$L_{nw}54\text{dB}$**
 $R_w + C_{tr}= 54\text{dB}$

The subsequent improvement in airborne and impact reduction is strongly advised.

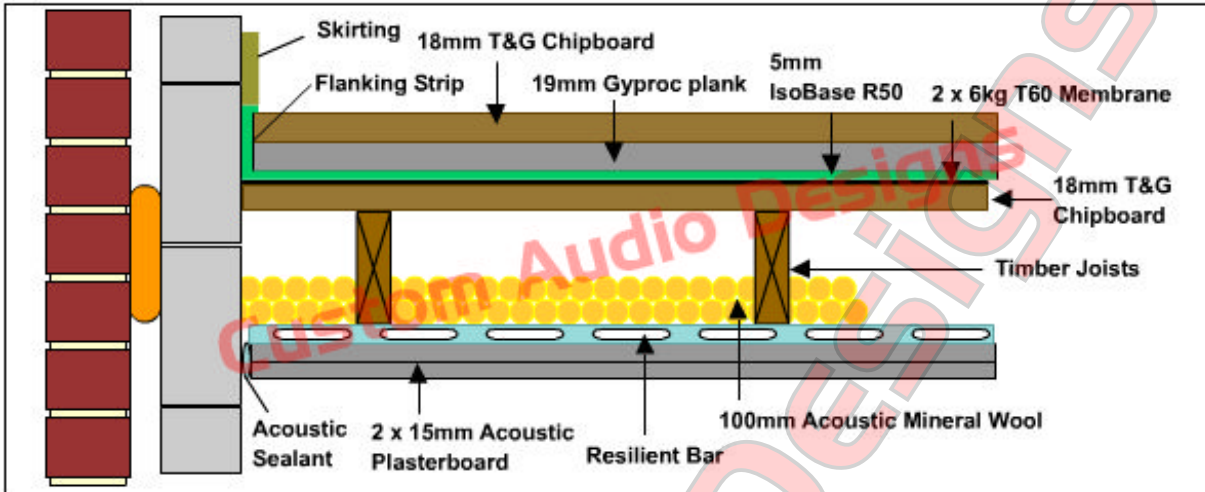

PLEASE NOTE:

If existing floorboards, with gaps between them, are to be re-used it is essential that the floor is well sealed first with the two layers of the 6kg T60 heavy weight membrane.

All information contained in these details is given in good faith but without warranty.
Custom Audio Designs reserves the right to alter the specifications of any product without notice.