

# Acoustifloor



Acoustifloor is a superb, ultra thin, acoustic flooring system made up of a laminate of the 8000 Acoustic Membrane and a high performance foamed polyethylene specially selected for its acoustic performance. The product is only 6mm thick and is supplied in 7.5m x 1.5m rolls to allow customers to specify their own floor finish. It can be used on conversion and new build projects in conjunction with wooden joisted timber floors or concrete floors.

Incorporating the latest changes to the Approved Document E 2003, the minimum and maximum sound insulation requirement for separating floors are as follows:

|                   | Airborne Sound Reduction $D_{nT,W}+C_{tr}$ | Impact Sound Level $L_{nT,W}$ |
|-------------------|--|-------------------------------|
| <b>CONVERSION</b> | 43dB or greater                            | 64dB or less                  |
| <b>NEW BUILD</b>  | 45dB or greater                            | 62dB or less                  |

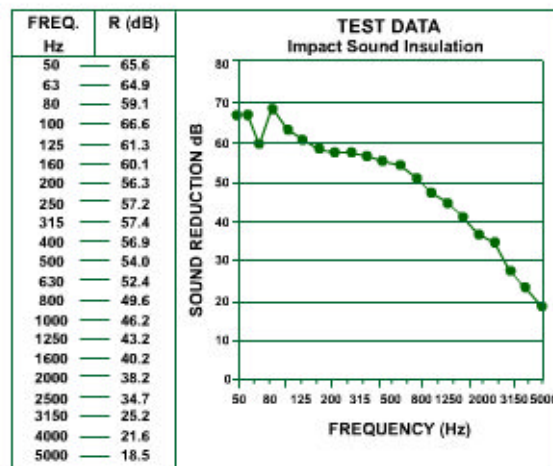
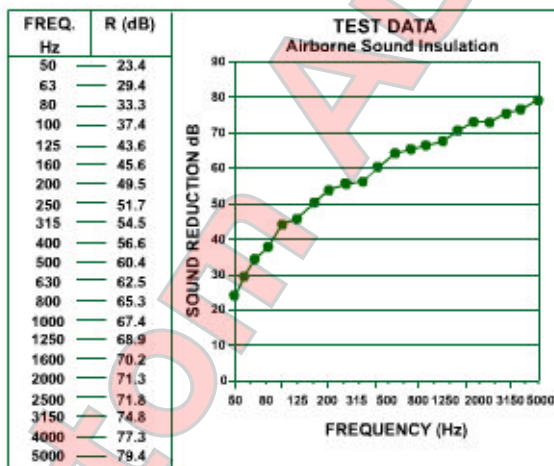
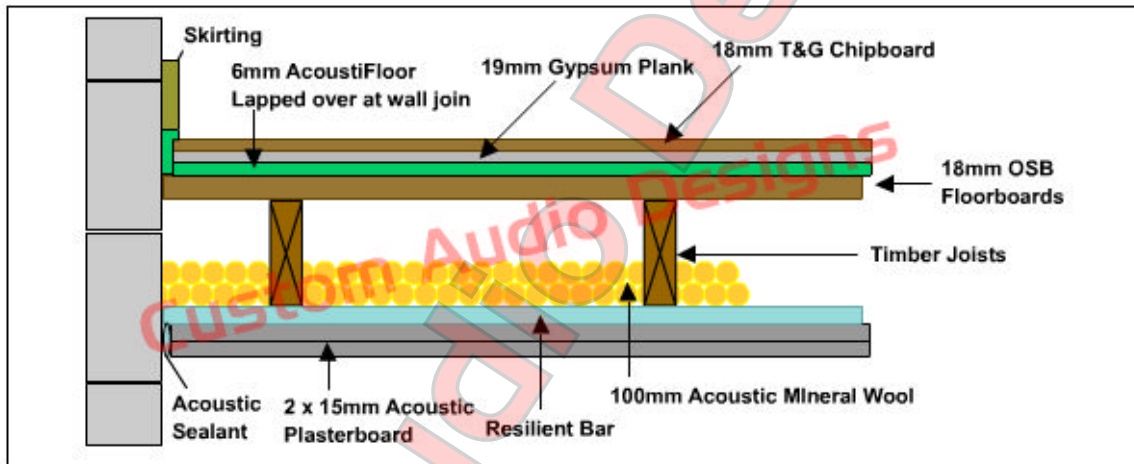

Tested Performance of the Above Structure:-

$$R_w = 62\text{dB} (C_{tr} - 8) \quad L_{n,w} = 54\text{dB}$$

$$R_w + C_{tr} = 54\text{dB}$$

# ROBUST DETAIL SOLUTION

SEPARATING FLOORS / CONCRETE FLOOR / ROBUST DETAIL FLOATING FLOOR TREATMENT 4 / Rd  
Delta L<sub>w</sub>19dB

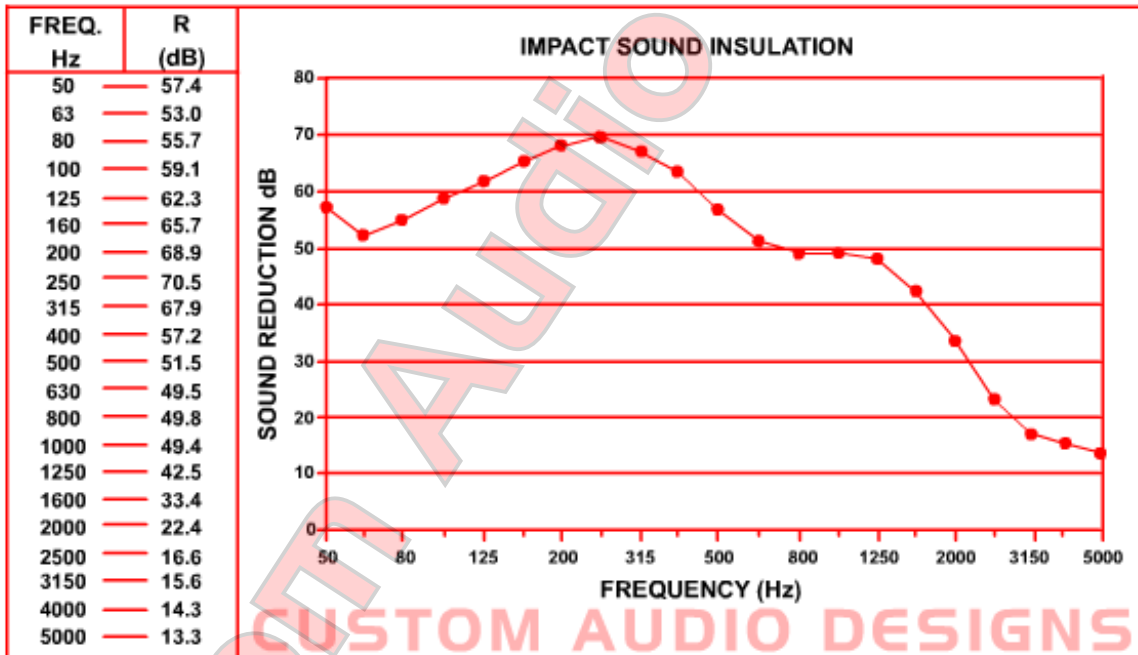
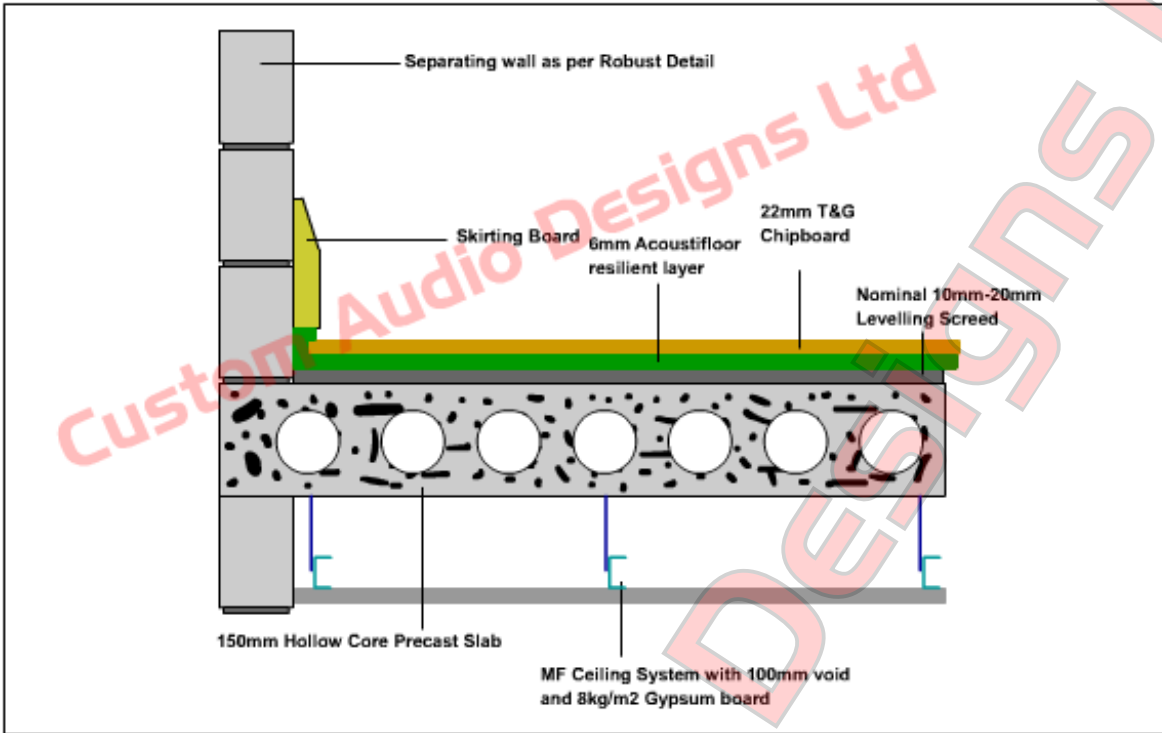

## INSTALLATION

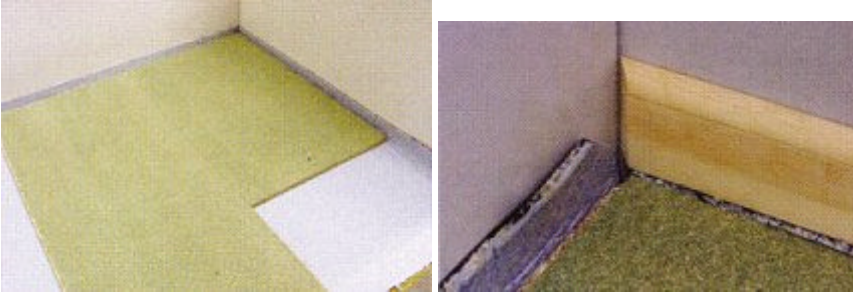

- Roll out the material ensuring that the black membrane is facing down.
- Where it butts a wall allow 50mm overlap at each edge and cut using a sharp knife or scissors.
- Where it butts push tightly together and tape along the edge and cut using our aluminium duct tape.
- At the corners notch by accurately cutting out a 50mm square.
- Follow manufacturers instructions for installing tongue and groove boards. Lay the T&G boards over the AcoustiFloor preferably at right angles or alternatively if joints are running in the same direction stagger the joints. Glue the T&G joints.
- Mitre the AcoustiFloor by turning down each flap in turn and trimming off at a 45° angle.
- Turn the AcoustiFloor over the top of the floorboard and fit skirting so as to trap the overlap underneath.
- Trim the excess with a sharp knife.
- Finish off by applying our acoustic sealant to the joint.

You have now created a floating floor which is decoupled from the base floor and surrounding walls reducing the transmission of sound through the structure and by flanking and leakage.

### AcoustiFloor as a sound reduction Carpet Underlay

- Roll out the material ensuring that the black membrane is facing down.
- Where it butts push tightly together and tape along the edge and cut using our aluminium duct tape.
- Glue to base floor using our spray adhesive.
- Fit as per standard carpet underlay.
- Lay carpet as per suppliers instructions.

## SPECIFICATION

Roll size: 7.5m x 1.5m x 6mm